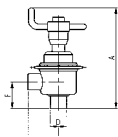
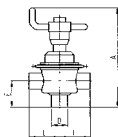

ΧΕΙΡΟΚ. ΒΑΝ. 2-ΟΔΗ L ΣΥΓΚ.
 MANUAL V. 2 W. L PE.
 V. MANUELLE 2 V. L BL.
 V. MANUAL 2 V. L EL.

850 L

DN	A	D	E	L	gr
20	245,0	20,0	44,5	66,5	2.150
34	254,0	34,0	53,0	66,5	2.170
40	256,0	40,0	49,0	66,5	2.170
52	290,0	52,0	58,0	74,0	2.600
70	365,0	70,0	71,0	95,0	4.500
85	388,0	85,0	83,0	95,0	7.750

ΧΕΙΡΟΚ. ΒΑΝ. 3-ΟΔΗ T ΣΥΓΚ.
 MANUAL V. 3 W. T PE.
 V. MANUELLE 3 V. T BL.
 V. MANUAL 3 V. T EL.

855 L

DN	A	D	E	L	gr
20	245,0	20,0	44,5	66,5	2.200
34	254,0	34,0	53,0	66,5	2.190
40	250,0	40,0	49,0	66,5	2.200
52	290,0	52,0	58,0	74,0	2.730
70	365,0	70,0	71,0	95,0	4.780
85	388,0	85,0	83,0	95,0	7.840

ΧΕΙΡΟΚ. ΒΑΝ. 3-ΟΔΗ LL ΣΥΓΚ.
 MANUAL V. 3 W. LL PE.
 V. MANUELLE 3 V. LL BL.
 V. MANUAL 3 V. LL EL.

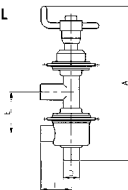
860 L

DN	A	D	E	L	gr
20	326,0	20,0	81,0	66,5	2.540
34	335,0	34,0	81,0	66,5	2.550
40	331,0	40,0	81,0	66,5	2.560
52	385,0	52,0	95,0	74,0	3.230
70	480,0	70,0	115,0	95,0	5.850
85	519,0	85,0	131,0	95,0	9.100

ΧΕΙΡΟΚ. ΒΑΝ. 4-ΟΔΗ LT ΣΥΓΚ.
 MANUAL V. 4 W. LT PE.
 V. MANUELLE 4 V. LT BL.
 V. MANUAL 4 V. LT EL.

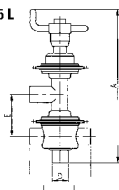
865 L

DN	A	D	E	L	gr
20	326,0	20,0	81,0	66,5	2.600
34	330,0	34,0	81,0	66,5	2.610
40	331,0	40,0	81,0	66,5	2.600
52	385,0	52,0	95,0	74,0	3.260
70	480,0	70,0	115,0	95,0	5.950
85	519,0	85,0	131,0	95,0	9.250

ΧΕΙΡΟΚ. ΒΑΝ. 2-ΟΔΗ L ΣΠΕΙΡ.
 MANUAL V. 2 W. L ME.
 V. MANUELLE 2 V. L BF.
 V. MANUAL 2 V. L ER.

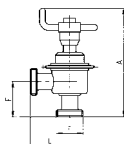
851 D

DN	A	E	F	L	gr
25	259,0	99,0	52-6	81,0	2.300
32	268,0	67,0	58-6	81,0	2.350
40	263,0	62,0	65-6	80,0	2.400
50	303,0	71,0	78-6	87,0	2.990
65	380,0	86,0	95-6	110,0	4.950
80	405,0	100,0	110-4	112,0	8.350

ΧΕΙΡΟΚ. ΒΑΝ. 3-ΟΔΗ T ΣΠΕΙΡ.
 MANUAL V. 3 W. T ME.
 V. MANUELLE 3 V. T BF.
 V. MANUAL 3 V. T ER.

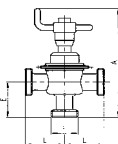
856 D

DN	A	E	F	L	gr
25	259,0	99,0	52-6	81,0	2.380
32	268,0	67,0	58-6	81,0	2.450
40	263,0	62,0	65-6	80,0	2.520
50	303,0	71,0	78-6	87,0	3.150
65	380,0	86,0	95-6	110,0	5.300
80	405,0	100,0	110-4	112,0	8.740

ΧΕΙΡΟΚ. ΒΑΝ. 3-ΟΔΗ LL ΣΠΕΙΡ.
 MANUAL V. 3 W. LL ME.
 V. MANUELLE 3 V. LL BF.
 V. MANUAL 3 V. LL ER.

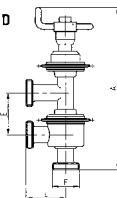
861 D

DN	A	E	F	L	gr
25	340,0	81,0	52-6	81,0	2.740
32	349,0	81,0	58-6	81,0	2.800
40	344,0	81,0	65-6	80,0	2.890
50	398,0	95,0	78-6	87,0	3.650
65	495,0	115,0	95-6	110,0	6.420
80	536,0	131,0	110-4	112,0	10.000

ΧΕΙΡΟΚ. ΒΑΝ. 4-ΟΔΗ LT ΣΠΕΙΡ.
 MANUAL V. 4 W. LT ME.
 V. MANUELLE 4 V. LT BF.
 V. MANUAL 4 V. LT ER.

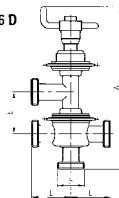
866 D

DN	A	E	F	L	gr
25	340,0	81,0	52-6	81,0	2.840
32	349,0	81,0	58-6	81,0	2.920
40	344,0	81,0	65-6	80,0	3.020
50	398,0	95,0	78-6	87,0	3.820
65	495,0	115,0	95-6	110,0	6.710
80	536,0	131,0	110-4	112,0	10.450