

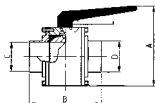

ΒΑΝ. ΣΦΑΙΡ. ΔΙΑΙΡ. ΥΓΙΕΙΝ. ΤΥΠΟΥ
SANIT. EXTRACTABLE BALL V. PE.
V. BOULE EXTRACT. SANIT. BL.
V. BOLA EXTRAIBLE SANIT. EL.

W90



DN	A	B	C	D	gr
28	110,0	96,0	25,0	28,0	1.130
34	130,0	109,0	31,0	34,0	2.070
40	130,0	109,0	37,0	40,0	2.070
52	145,0	124,0	49,0	52,0	2.800
70	168,0	135,0	66,0	70,0	4.840
85	182,0	158,0	81,0	85,0	7.480

ΒΑΝ. ΣΦΑΙΡ. ΔΙΑΙΡ. ΥΓΙΕΙΝ. ΤΥΠ. ΣΠΕΙΡ.
SANIT. EXTRACTABLE BALL V. ME.
V. BOULE EXTRACT. SANIT. BF.
V. BOLA EXTRAIBLE SANIT. ER.

D90

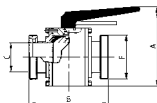

DN	A	B	C	F	gr
25	110,0	88,0	25,0	52-6	1.230
32	130,0	103,0	31,0	58-6	2.220
40	130,0	103,0	37,0	65-6	2.220
50	145,0	116,0	49,0	78-6	2.950
65	168,0	134,0	66,0	95-6	5.140
80	182,0	153,0	81,0	110-4	7.780

ΒΑΝ. ΣΦΑΙΡ. ΔΙΑΙΡ. ΥΓΙΕΙΝ. ΤΥΠ.
SANIT. EXTRACT. BALL V. PE./ME.
V. BOULE EXTR. SANIT. BL./BF.
V. BOLA EXTR. SANIT. EL./ER.

WD90

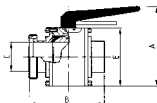

DN	A	B	C	E	gr
25	110,0	91,5	25,0	60,0	1.320
32	130,0	106,0	31,0	80,0	2.370
40	130,0	106,0	37,0	80,0	2.370
50	145,0	120,0	49,0	95,0	3.100
65	168,0	134,5	66,0	118,0	5.440
80	182,0	155,5	81,0	132,0	8.080

ΒΑΝ. ΣΦΑΙΡΑΣ ΔΙΑΙΡ. ΕΛΕΥΘ. ΑΚΡΑ
EXTRACTABLE BALL V. PE.
V. BOULE EXTRACTIBLE BL.
V. BOLA EXTRAIBLE EL.

W91

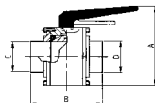

DN	A	B	C	D	gr
28	110,0	96,0	25,0	28,0	1.120
34	130,0	109,0	31,0	34,0	2.060
40	130,0	109,0	37,0	40,0	2.060
52	145,0	124,0	49,0	52,0	2.780
70	168,0	135,0	66,0	70,0	4.820
85	182,0	158,0	81,0	85,0	7.450

ΒΑΝ. ΣΦΑΙΡΑΣ ΔΙΑΙΡ. ΜΕ ΣΠΕΙΡΩΜ.
EXTRACTABLE BALL V. ME.
V. BOULE EXTRACTIBLE BF.
V. BOLA EXTRAIBLE ER.

D91

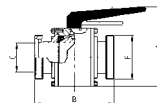

DN	A	B	C	F	gr
25	110,0	88,0	25,0	52-6	1.220
32	130,0	103,0	31,0	58-6	2.210
40	130,0	103,0	37,0	65-6	2.210
50	145,0	116,0	49,0	78-6	2.930
65	168,0	134,0	66,0	95-6	5.120
80	182,0	153,0	81,0	110-4	7.750

ΒΑΝ. ΣΦΑΙΡΑΣ ΔΙΑΙΡ. ΣΠΕΙΡ./Ε.Α.
EXTRACTABLE BALL V. PE./ME.
V. BOULE EXTRACTIBLE BL./BF.
V. BOLA EXTRAIBLE EL./ER.

WD91

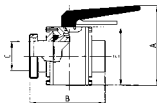

DN	A	B	C	E	gr
25	110,0	91,5	25,0	60,0	1.320
32	130,0	106,0	31,0	80,0	2.360
40	130,0	106,0	37,0	80,0	2.360
50	145,0	120,0	49,0	95,0	3.080
65	168,0	134,5	66,0	118,0	5.420
80	182,0	155,5	81,0	132,0	8.050