

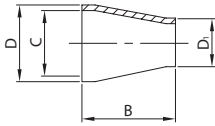
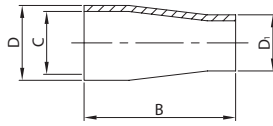
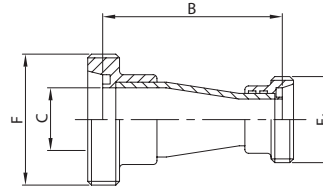

WG. CONC. REDUCER
169 L

DN	B	C	D	D ₁	gr
18/12	38,0	15,5	18,0	12,0	30
22/12	38,0	19,5	22,0	12,0	40
22/18	38,0	19,5	22,0	18,0	40
28/12	38,0	25,0	28,0	12,0	50
28/18	38,0	25,0	28,0	18,0	50
28/22	38,0	25,0	28,0	22,0	50
34/28	67,0	31,0	34,0	28,0	60
40/28	67,0	37,0	40,0	28,0	60
40/34	67,0	37,0	40,0	34,0	60
52/28	67,0	49,0	52,0	28,0	100
52/34	67,0	49,0	52,0	34,0	100
52/40	67,0	49,0	52,0	40,0	110
70/40	67,0	66,0	70,0	40,0	120
70/52	67,0	66,0	70,0	52,0	160
85/40	88,0	81,0	85,0	40,0	180
85/52	67,0	81,0	85,0	52,0	190
85/70	67,0	81,0	85,0	70,0	240
101/52	105,0	97,6	101,6	52,0	300
101/70	72,0	97,6	101,6	70,0	290
101/85	67,0	97,6	101,6	85,0	280
104/52	107,0	100,0	104,0	52,0	300
104/70	72,0	100,0	104,0	70,0	290
104/85	67,0	100,0	104,0	85,0	280

CONC. REDUCER PE.
170 L

DN	B	C	D	D ₁	gr
18/12	67,0	15,5	18,0	12,0	30
22/12	67,0	19,5	22,0	12,0	40
22/18	67,0	19,5	22,0	18,0	40
28/12	67,0	25,0	28,0	12,0	50
28/18	67,0	25,0	28,0	18,0	50
28/22	67,0	25,0	28,0	22,0	50
34/12	67,0	31,0	34,0	12,0	80
34/18	67,0	31,0	34,0	18,0	80
34/22	98,0	31,0	34,0	22,0	90
34/28	88,0	31,0	34,0	28,0	90
40/12	67,0	37,0	40,0	12,0	100
40/18	67,0	37,0	40,0	18,0	110
40/22	105,0	37,0	40,0	22,0	110
40/28	98,0	37,0	40,0	28,0	120
40/34	88,0	37,0	40,0	34,0	120
52/28	134,0	49,0	52,0	28,0	155
52/34	105,0	49,0	52,0	34,0	210
52/40	98,0	49,0	52,0	40,0	180
70/34	120,0	66,0	70,0	34,0	220
70/40	120,0	66,0	70,0	40,0	220
70/52	105,0	66,0	70,0	52,0	270
85/40	147,0	81,0	85,0	40,0	440
85/52	125,0	81,0	85,0	52,0	430
85/70	105,0	81,0	85,0	70,0	500
101/52	155,0	97,6	101,6	52,0	560
101/70	127,0	97,6	101,6	70,0	550
101/85	120,0	97,6	101,6	85,0	550
104/52	165,0	100,0	104,0	52,0	530
104/70	127,0	100,0	104,0	70,0	525
104/85	120,0	100,0	104,0	85,0	550

CONC. RED. MP./MP. ED.
171 D

DN	B	C	F	F ₁	gr
32/25	94,0	31,0	58-6	52-6	390
40/25	115,0	37,0	65-6	52-6	460
40/32	101,0	37,0	65-6	58-6	500
50/25	128,0	49,0	78-6	52-6	570
50/32	142,0	49,0	78-6	58-6	660
50/40	125,0	49,0	78-6	65-6	670
65/40	130,0	66,0	95-6	65-6	810
65/50	148,0	66,0	95-6	78-6	930
80/65	136,0	81,0	110-4	95-6	1.410
100/80	138,0	97,6	130-4	110-4	2.150
104/80	138,0	100,0	130-4	110-4	2.150

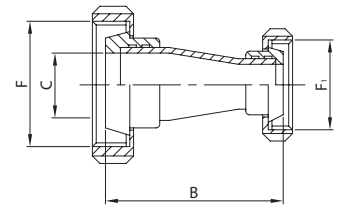
CONC. RED. TRN./TRN. ED.
172 D

DN	B	C	F	F ₁	gr
32/25	94,0	31,0	58-6	52-6	635
40/25	115,0	37,0	65-6	52-6	740
40/32	101,0	37,0	65-6	58-6	795
50/25	128,0	49,0	78-6	52-6	920
50/32	142,0	49,0	78-6	58-6	1.030
50/40	125,0	49,0	78-6	65-6	1.075
65/40	130,0	66,0	95-6	65-6	1.430
65/50	148,0	66,0	95-6	78-6	1.545
80/65	136,0	81,0	110-4	95-6	2.415
100/80	138,0	97,6	130-4	110-4	3.470
104/80	138,0	100,0	130-4	110-4	3.470

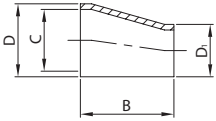
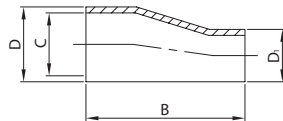
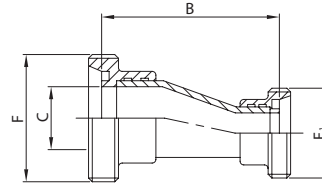
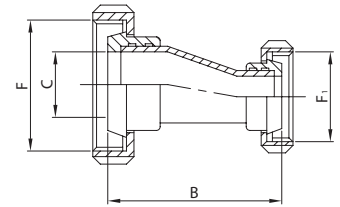
WG. ECC. REDUCER
ECC. REDUCER PE.
ECC. RED. MP./MP. ED.
ECC. RED. TP. N./TP. N. ED.
179 L

180 L

181 D

182 D

DN	B	C	D	D ₁	gr
34/28	67,0	31,0	34,0	28,0	60
40/28	67,0	37,0	40,0	28,0	60
40/34	67,0	37,0	40,0	34,0	60
52/28	68,0	49,0	52,0	28,0	100
52/34	67,0	49,0	52,0	34,0	100
52/40	67,0	49,0	52,0	40,0	110
70/40	71,0	66,0	70,0	40,0	120
70/52	67,0	66,0	70,0	52,0	160
85/52	79,0	81,0	85,0	52,0	190
85/70	67,0	81,0	85,0	70,0	240
101/52	110,0	97,6	101,6	52,0	300
101/70	67,0	97,6	101,6	70,0	290
101/85	67,0	97,6	101,6	85,0	280
104/52	110,0	100,0	104,0	52,0	300
104/70	67,0	100,0	104,0	70,0	290
104/85	67,0	100,0	104,0	85,0	280

DN	B	C	D	D ₁	gr
34/28	102,0	31,0	34,0	28,0	120
40/28	110,0	37,0	40,0	28,0	120
40/34	102,0	37,0	40,0	34,0	130
52/28	130,0	49,0	52,0	28,0	160
52/34	120,0	49,0	52,0	34,0	200
52/40	110,0	49,0	52,0	40,0	160
70/40	153,0	66,0	70,0	40,0	230
70/52	130,0	66,0	70,0	52,0	240
85/52	146,0	81,0	85,0	52,0	430
85/70	120,0	81,0	85,0	70,0	500
101/52	150,0	97,6	101,6	52,0	560
101/70	153,0	97,6	101,6	70,0	550
101/85	118,0	97,6	101,6	85,0	550
104/52	148,0	100,0	104,0	52,0	530
104/70	153,0	100,0	104,0	70,0	525
104/85	118,0	100,0	104,0	85,0	550

DN	B	C	F	F ₁	gr
32/25	116,0	31,0	58-6	52-6	422
40/25	123,0	37,0	65-6	52-6	462
40/32	115,0	37,0	65-6	58-6	510
50/25	143,0	49,0	78-6	52-6	572
50/32	133,0	49,0	78-6	58-6	650
50/40	122,0	49,0	78-6	65-6	670
65/40	166,0	66,0	95-6	65-6	875
65/50	143,0	66,0	95-6	78-6	900
80/65	136,0	81,0	110-4	95-6	1.410
100/80	136,0	97,6	130-4	110-4	2.180
104/80	136,0	100,0	130-4	110-4	2.180

DN	B	C	F	F ₁	gr
32/25	116,0	31,0	58-6	52-6	665
40/25	123,0	37,0	65-6	52-6	740
40/32	115,0	37,0	65-6	58-6	805
50/25	143,0	49,0	78-6	52-6	925
50/32	133,0	49,0	78-6	58-6	1.020
50/40	122,0	49,0	78-6	65-6	1.055
65/40	166,0	66,0	95-6	65-6	1.400
65/50	143,0	66,0	95-6	78-6	1.595
80/65	136,0	81,0	110-4	95-6	2.415
100/80	136,0	97,6	130-4	110-4	3.500
104/80	136,0	100,0	130-4	110-4	3.500