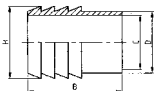
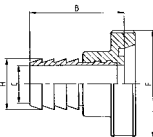

ΑΚΡΟΣΩΛΗΝΙΟ
 HOSE CONNECTION PE.
 MANCHON A LIGATURER
 MANGUITO MANGUERA EL.

140 L

DN	B	C	D	H	gr
28	42,0	25,0	28,0	34,0	80
34	45,0	31,0	34,0	40,0	105
40	52,0	37,0	40,0	46,0	145
52	58,0	49,0	52,0	58,0	210
70	72,0	66,0	70,0	76,0	380
85	73,0	81,0	85,0	93,0	570
101	95,0	97,6	101,6	114,0	1.400

ΑΚΡΟΣΩΛΗΝΙΟ ΜΕ ΑΡΣΕΝΙΚΟ ΣΤΟΜΙΟ
 HOSE CONN. + MP. ED.
 NEZ FILETE A LIGATURER
 M. M. MACHO MD.

141 D

DN	B	C	F	H	gr
25	49,0	25,0	52-6	34,0	212
32	52,0	31,0	58-6	40,0	275
40	58,0	37,0	65-6	46,0	355
50	65,0	49,0	78-6	58,0	490
65	79,0	66,0	95-6	76,0	760
80	82,0	81,0	110-4	93,0	1.170
100	104,0	97,6	130-4	114,0	2.400

ΑΚΡΟΣΩΛΗΝΙΟ ΜΕ ΚΩΝΙΚΟ ΣΤΟΜΙΟ
 HOSE CONN. + TP. ED.
 DOUILLE A LIGATURER
 M. M. CASQUILLO MD.

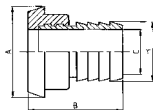
142 D

DN	A	B	C	H	gr
25	44,0	49,0	25,0	34,0	165
32	50,0	52,0	31,0	40,0	215
40	56,0	58,0	37,0	46,0	280
50	68,0	65,0	49,0	58,0	410
65	86,0	79,0	66,0	76,0	675
80	100,0	82,0	81,0	93,0	950
100	121,0	104,0	97,6	114,0	2.180

ΑΚΡΟΣΩΛΗΝΙΟ ΜΕ ΑΡΣΕΝΙΚΟ ΣΤΟΜΙΟ
 CONN. RUBBER ME.
 PORTE C. NEZ FILETE
 M. M. MACHO SR.

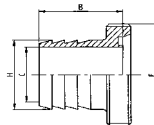
143 D

DN	B	C	F	H	gr
10	38,0	10,0	29-6	18,0	80
15	38,0	16,0	34-8	24,0	115
20	38,0	20,0	44-6	30,0	180
25	37,0	25,0	52-6	34,0	212
32	37,0	31,0	58-6	40,0	275
40	42,0	37,0	65-6	46,0	355
50	47,0	49,0	78-6	58,0	490
65	58,0	66,0	95-6	76,0	760
80	62,0	81,0	110-4	93,0	1.170
100	77,0	97,6	130-4	114,0	2.400

ΑΚΡΟΣΩΛΗΝΙΟ ΜΕ ΚΩΝΙΚΟ ΣΤΟΜΙΟ
 CONN. RUBBER TE.
 PORTE C. DOUILLE
 M. M. CASQUILLO SR.

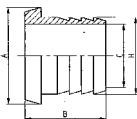
144 D

DN	A	B	C	H	gr
10	22,0	36,0	10,0	18,0	65
15	28,0	36,0	16,0	24,0	90
20	36,0	38,0	20,0	30,0	140
25	44,0	40,0	25,0	34,0	185
32	50,0	40,0	31,0	40,0	215
40	56,0	45,0	37,0	46,0	280
50	68,0	51,0	49,0	58,0	410
65	86,0	62,0	66,0	76,0	675
80	100,0	62,0	81,0	93,0	950
100	121,0	80,0	97,6	114,0	2.180