

**EMF**

## Bottom entry mixer

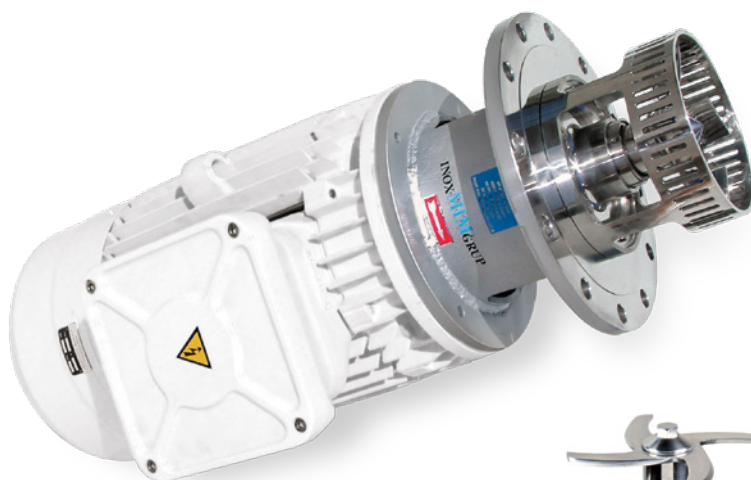

INOXMIM has designed a wide range of bottom entry mixers which meet all requirements in product dispersing, mixing, homogenising and crushing processes.

EMF --- mixers are installed in the bottom of the vessel and carry out highly efficient dissolving of the heaviest particles of the product. When turning, the turbine generates the suction required to draw the fluid towards the centre of the headpiece, where centrifugal force directs it toward the outside of the rotor. Once the space between the turbine and the stator is reached, the product is subjected to high pressure which leads to crushing. It then passes through the high turning speed headpiece orifices, generating a very high shearing strain which leads to dispersion, emulsification and homogenisation of the mix, as this process is repeated continuously.

This high level of shearing, combined with the different types of headpieces (perforated, slotted or sieved), generates the ideal particle size for stable emulsions and homogeneous mixes. These units can be used in an agitator system fitted with an anchor impeller for high viscosity products, or can work alone if the product has low viscosity. All these features make these units essential in sectors as demanding as the food, pharmaceutical and cosmetics industries.

### MODELS

**EMF 0.75-50**  
**EMF 1.5-100**  
**EMF 4-500**  
**EMF 7.5-1500**  
**EMF 11-2.500**  
**EMF 15-5.000**  
**EMF 18.5-10000**

### CHARACTERISTICS

DIN 2576 PN10 Anchor flange  
 Adjustable head and turbine design  
 High degree of hygiene  
 Interchangeable heads: slotted, sieved or perforated  
 Easy assembly/dismounting  
 Double mechanical seal

### MATERIALS

Parts in contact with the product in stainless steel AISI 316  
 Level of finish: Foodstuff / Sanitary

### OPTIONS

Single mechanical seal with safety stuffing  
 Control panel  
 Speed variator  
 Diffuser and turbine in other materials  
 Motor cover  
 Cooling unit for the seal system  
 Multi-turbine

## DIMENSIONS AND CHARACTERISTICS OF THE EMF MODEL

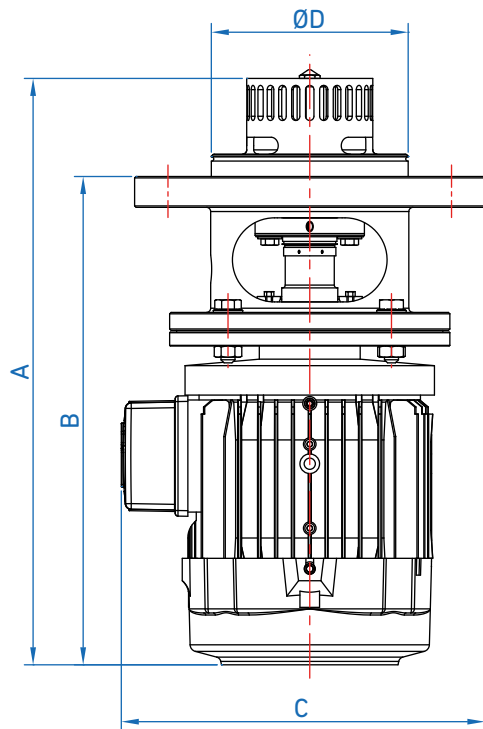

### DIN 2576 PN10 FLANGE MIXER BASE

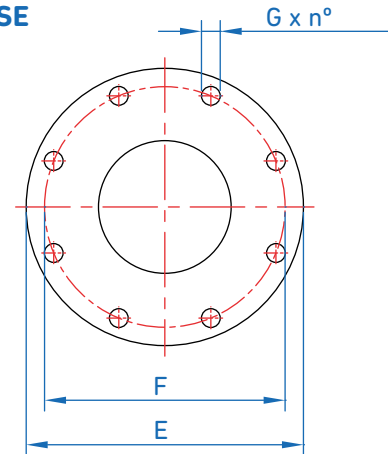

#### OVERALL DIMENSIONS

| MODEL          | E     | F    | G   | n° |        |
|----------------|-------|------|-----|----|--------|
| EMF 0.75-50    | DN80  | Ø200 | 160 | 18 | 8x45°  |
| EMF 1.5-100    | DN125 | Ø250 | 210 | 18 | 8x45°  |
| EMF 4-500      | DN125 | Ø250 | 210 | 18 | 8x45°  |
| EMF 7.5-1500   | DN150 | Ø285 | 240 | 22 | 8x45°  |
| EMF 11-2500    | DN200 | Ø340 | 294 | 22 | 8x45°  |
| EMF 15-5000    | DN250 | Ø395 | 350 | 22 | 12x30° |
| EMF 18.5-10000 | DN250 | Ø395 | 350 | 22 | 12x30° |

#### OVERALL DIMENSIONS

| MODEL          | Pot.<br>(kW) | A   | B   | C   | ØD  | (kg) |
|----------------|--------------|-----|-----|-----|-----|------|
| EMF 0.75-50    | 0.75         | 377 | 311 | 225 | 89  | 21   |
| EMF 1.5-100    | 1.5          | 445 | 366 | 235 | 89  | 29   |
| EMF 4-500      | 4            | 535 | 454 | 265 | 140 | 46   |
| EMF 7.5-1500   | 7.5          | 711 | 618 | 312 | 169 | 76   |
| EMF 11-2500    | 11           | 730 | 630 | 357 | 220 | 110  |
| EMF 15-5000    | 15           | 765 | 642 | 385 | 274 | 131  |
| EMF 18.5-10000 | 18.5         | 765 | 645 | 433 | 274 | 149  |

\*For higher models, please ask

